

SONAMP® DSP AMPLIFIERS

DSP 2-150 MKII, DSP 8-130 MKII & DSP 2-750 MKII MULTI-CHANNEL POWER AMPLIFIERS



Product Overview

Building on the legacy of the SONAMP 260, the industry's first purpose-built distributed audio amplifier, Sonance is pleased to announce the next generation of class-leading amplifiers. The new DSP amplifier line delivers game changing features, audiophile grade circuitry, robust power and unrivaled installation flexibility.

At the heart of the SONAMP DSP amplifier is the SONARC (Sonance Advanced Room Correction) web interface featuring 50+ **Sonance designed DSP presets**, preloaded for effortless DSP without the need for additional hardware or calibration. A built in 10-band parametric EQ allows for additional DSP customization.

Features and Benefits

- High resolution 24 bit/96 kHz processing DAC capable of 4608 KBPS audio playback.
- IP and IR controllable via SONARC™ V2 for the ultimate in installation flexibility.
- Powerful, audiophile grade Class-D amplification, rated and certified at 8 and 4 ohms & stable to 2 ohms.
- Compact form factor allows for space savings in the equipment rack with ample power to the speakers.
- Class-D design is 93% efficient for maximum power output with minimal power usage. Meets EU power saving standards.
- Terminal blocks will accept up to 12AWG speaker cable for longer runs and higher performance.
- Full array of input/output connectivity for maximum installation flexibility: Line input/loop outputs; IP, IR, audio and voltage triggers; Ethernet jack for network connectivity.
- Bridgeable channels for applications when even more power is required.
- Certified to worldwide safety standards. (TUV to UL standards, CE, RCM, C-Tick, RoHS, WEEE). Meets FCC standards.
- Rack ears and removable feet included.
- **Digital Input Module compatible**

DSP 2-150 MKII



DSP 8-130 MKII



DSP 2-750 MKII



DSP 2-150 MKII Dimensions

Dimensions with Feet

Width: 8 5/8" (219mm)
 Height: 2 1/8" (54mm)
 Depth: 16 13/16" (427mm)

Dimensions with Rack Ears & without Feet

Width: 19" (482mm)
 Height: 1 3/4" (44mm)
 Depth: 16 13/16" (427mm)

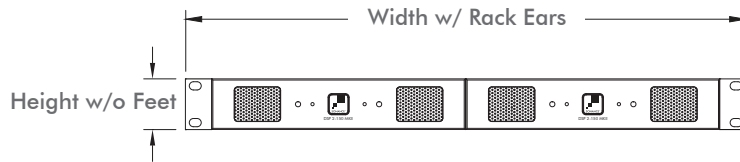
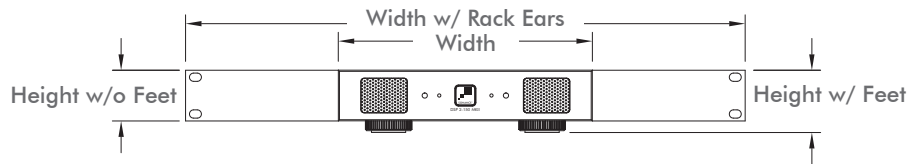
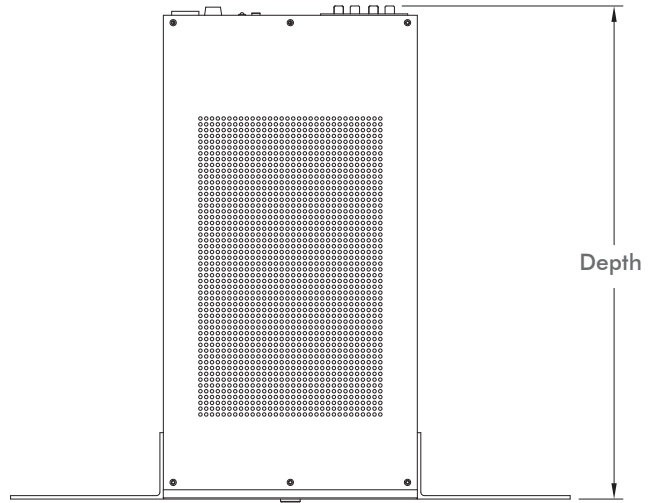

(2) DSP 2-150 amplifiers shown with optional Rack Mount Bracket

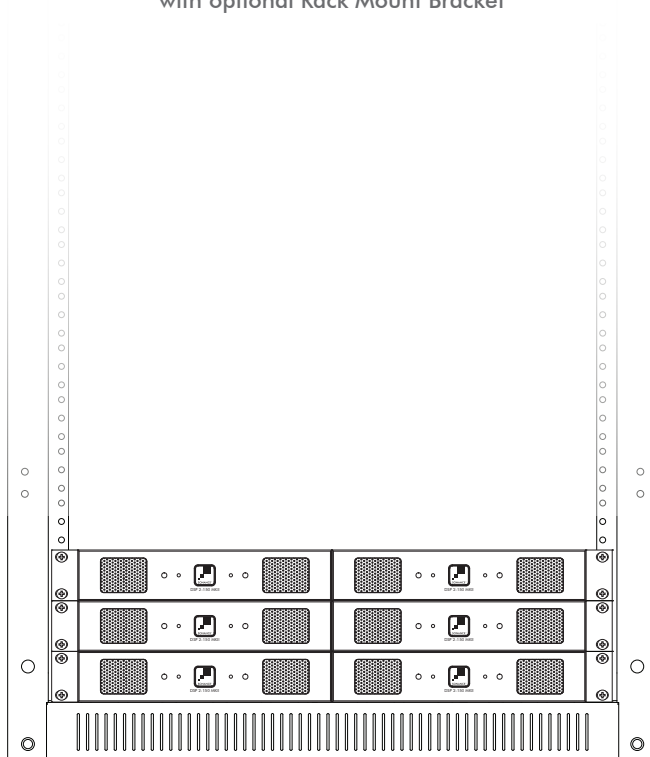

Shown with optional Rack Mount Bracket



SPECIFICATIONS **DSP 2-150 MKII**

SKU	93093
UOM	Each
Number of Channels	2 (1 stereo pair)
Power Output (RMS):	
RMS per channel @ 8 ohms	150 Watts (2 channels driven)
RMS per channel @ 4 ohms	224 Watts (2 channels driven)
RMS per channel Bridged @ 8 ohms	473 Watts
Frequency Response	5Hz – 50kHz
Total Harmonic Distortion (THD):	
(1kHz) @ 8 ohms	0.07%
(1kHz) @ 4 ohms	0.06%
AC Voltage	100-120V@60Hz, 220-240V@50Hz
AC Fuse	5A (T5-AL ~ 250V)
Dimensions w/ Feet (W x H x D)	8 5/8" x 2 1/8" x 16 13/16" (219mm x 54mm x 427mm)
Dimensions w/ Rack Ears w/o Feet (W x H x D)	19" x 1 3/4" x 16 13/16" (482mm x 44mm x 427mm)
Rack Space Requirement	1U
Shipping Weight	11 lbs (5.0kg)

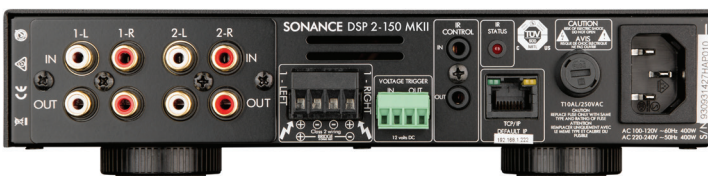

DSP 8-130 MKII Dimensions

Dimensions with Feet

Width: 17 1/4" (438mm)
 Height: 2 1/8" (54mm)
 Depth: 16 13/16" (427mm)

Dimensions with Rack Ears & without Feet

Width: 19" (482mm)
 Height: 1 3/4" (44mm)
 Depth: 16 13/16" (427mm)

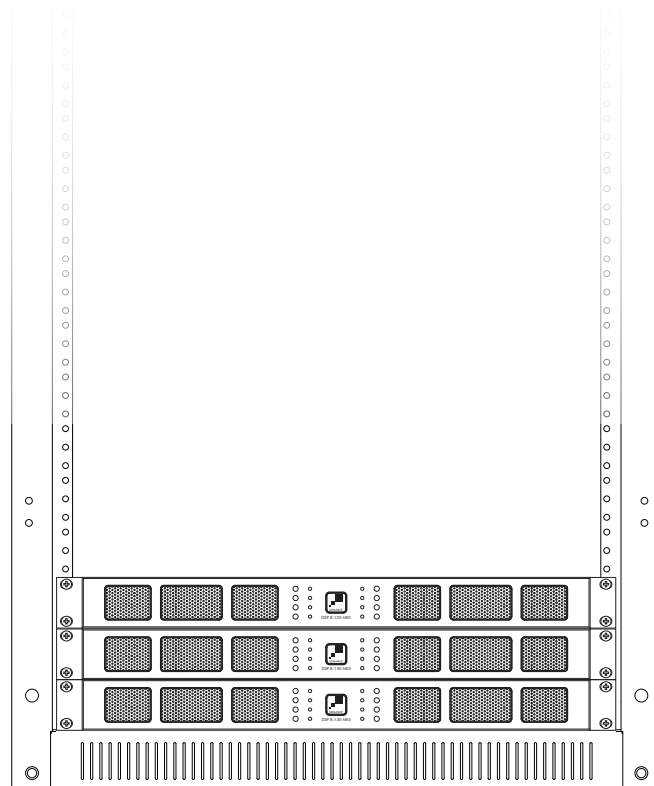
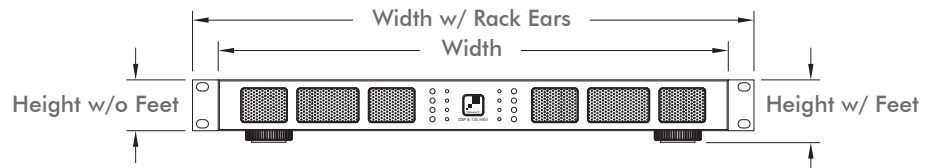
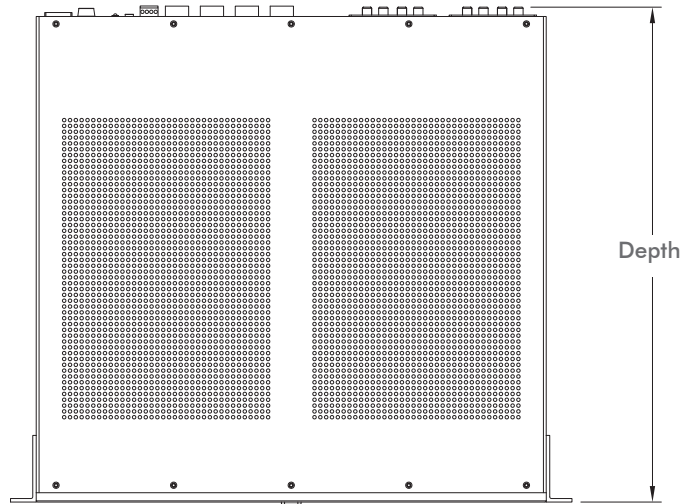



SPECIFICATIONS **DSP 8-130 MKII**

SKU	93331
UOM	Each
Number of Channels	8 (4 stereo pairs)
Power Output (RMS):	
RMS per channel @ 8 ohms	130 Watts (8 channels driven)
RMS per channel @ 4 ohms	145 Watts (8 channels driven)
RMS per channel Bridged @ 8 ohms	300 Watts
Frequency Response	5Hz – 50kHz
Total Harmonic Distortion (THD):	
(1kHz) @ 8 ohms	0.1%
(1kHz) @ 4 ohms	0.03%
AC Voltage	100-120V@60Hz, 220-240V@50Hz
AC Fuse	15A (T15-AL ~ 250V)
Dimensions w/ Feet (W x H x D)	17 1/4" x 2 1/8" x 16 13/16" (438mm x 54mm x 427mm)
Dimensions w/ Rack Ears w/o Feet (W x H x D)	19" x 1 3/4" x 16 13/16" (482mm x 44mm x 427mm)
Rack Space Requirement	1U
Shipping Weight	18 lbs (8.2kg)



DSP 2-750 MKII Dimensions

Dimensions with Feet

Width: 17 1/4" (438mm)
Height: 3 7/8" (98mm)
Depth: 17 7/32" (437mm)

Dimensions with Rack Ears & without Feet

Width: 19" (482mm)
Height: 3 1/2" (88mm)
Depth: 17 7/32" (437mm)

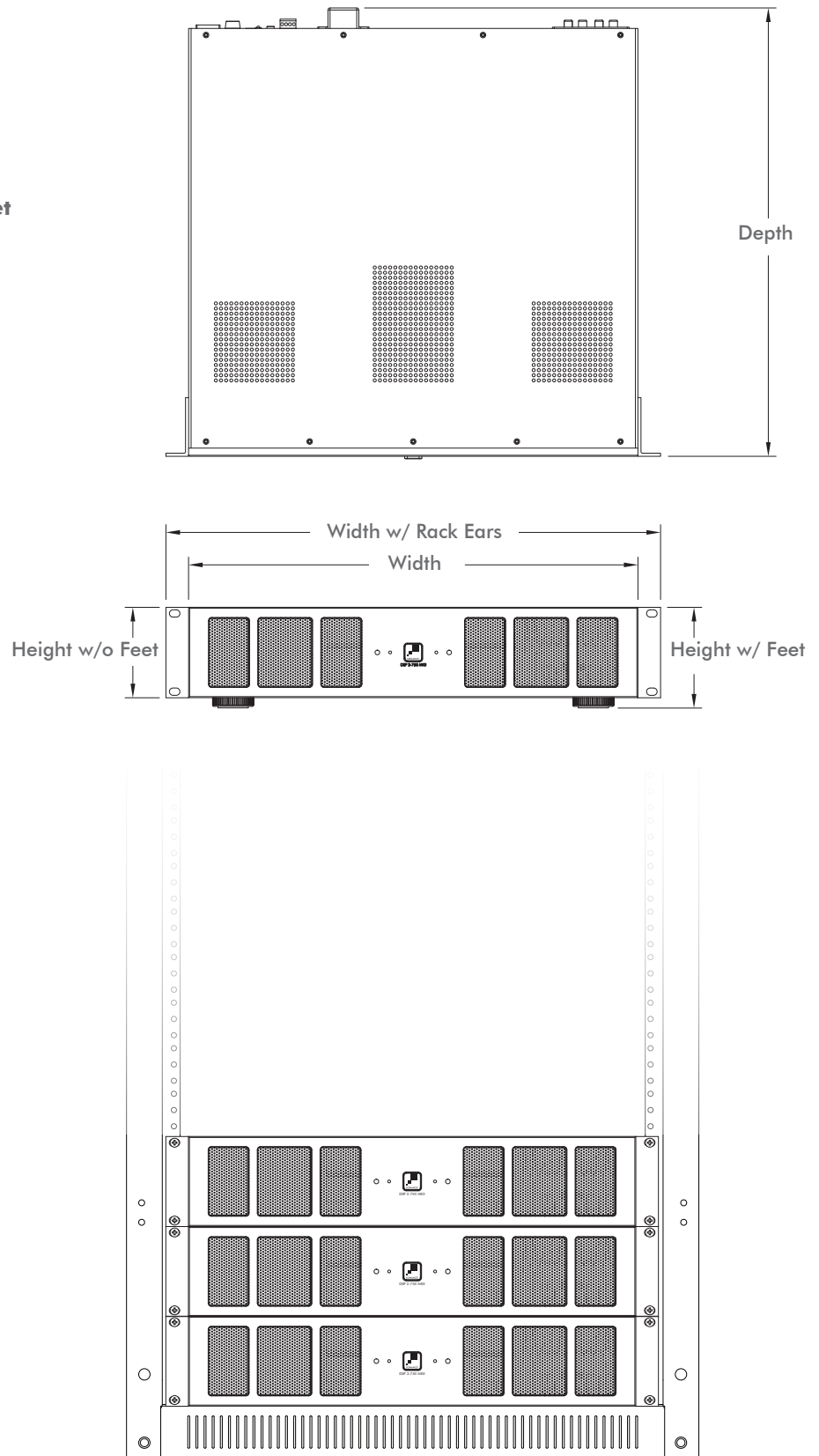



SPECIFICATIONS **DSP 2-750 MKII**

SKU	93095
UOM	Each
Number of Channels	2 (1 stereo pair)
Power Output (RMS):	
RMS per channel @ 8 ohms	500 Watts (2 channels driven)
RMS per channel @ 4 ohms / 70V	750 Watts (2 channels driven)
RMS per channel Bridged @ 8 ohms	2000 Watts
Frequency Response	5Hz – 50kHz
Total Harmonic Distortion (THD):	
(1kHz) @ 8 ohms	0.4%
(1kHz) @ 4 ohms	0.3%
AC Voltage	100-120V@60Hz, 220-240V@50Hz
AC Fuse	15A (T15-AL ~ 250V)
Dimensions w/ Feet (W x H x D)	17 1/4" x 3 7/8" x 17 7/32" (438mm x 98mm x 437mm)
Dimensions w/ Rack Ears w/o Feet (W x H x D)	19" x 3 1/2" x 17 7/32" (482mm x 88mm x 437mm)
Rack Space Requirement	2U
Shipping Weight	23.3 lbs (10.6kg)





Associated Products

Digital Input Module (DIM)

SKU# 93099

Compatible with DSP 2-150 MKII,
DSP 8-130 MKII (1 or 2)
and DSP 2-750 MKII



Rack Mount Bracket for
Sonamp 2-100 & DSP 2-150

SKU# 93098

Note: Allows two 1/2 rack width amps to be
rack mounted together in a 1U rack space.

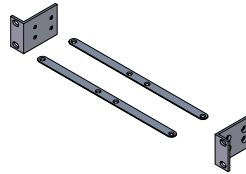

SONAMP DIGITAL AMPLIFIERS

2-100



12-50



LIMITED TWO (2) YEAR WARRANTY

Sonance warrants to the first end-user purchaser that this Sonance-brand product ("Product"), when purchased from an authorized Sonance Dealer/Distributor, will be free from defective workmanship and materials for two (2) years. Sonance will at its option and expense during the warranty period, either repair the defect or replace the Product with a new or remanufactured Product or a reasonable equivalent.



©2015 Sonance. All rights reserved.

Sonance and Sonamp are registered trademarks of Dana Innovations.

Due to continuous product improvement, all features and specifications are subject to change without notice. For the latest Sonance product specification information visit our website: www.sonance.com

SONANCE • 991 Calle Amanecer • San Clemente, CA 92673 USA
(949) 492-7777 • FAX: (949) 361-5151 • Technical Support: (949) 492-7777
www.sonance.com

SONARC

11.13.18